

217 EAST 96TH STREET

Residence 23F

CONVERTIBLE TWO BEDROOM TWO BATHS

880 Square Feet

81.75 Square Meters

Floor-to-Ceiling Windows

Entry Foyer

Master Bedroom with Walk-In Closet
and En Suite Bath

Washer/Dryer

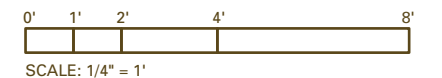
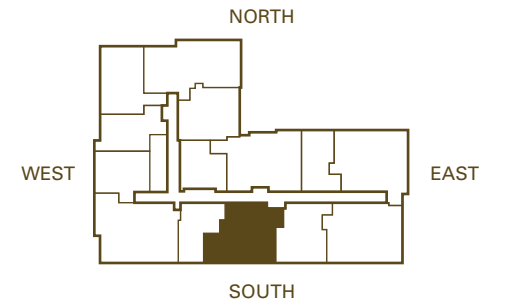

EXCLUSIVE MARKETING AND SALES AGENT

Related Sales LLC

(212) 249-8505

www.onecarnegiehillsales.com

www.related.com



This floorplan was prepared by the architect for One Carnegie Hill. All dimensions are approximate and subject to normal construction variances and tolerances. Plans and dimensions may contain minor variations from floor to floor. The complete offering terms are in an offering plan available from the sponsor: File No. CC-04-0003. Sponsor: One Carnegie Hill Associates, L.L.C., 60 Columbus Circle, New York, NY 10023.

RELATED

The Address of a Lifestyle

The Value of a Lifetime

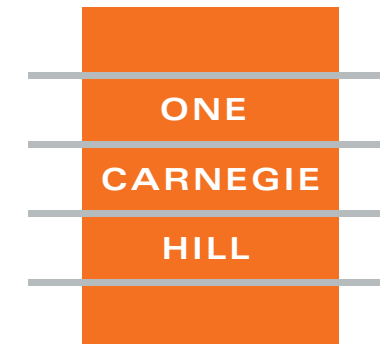

217 EAST 96TH STREET

Residence 23F

CONVERTIBLE
TWO BEDROOM
TWO BATHS

880 Square Feet
81.75 Square Meters