

- Corner Living Room
- Windowed Kitchen
- Ensuite Master Bath
- Walk-in Closet

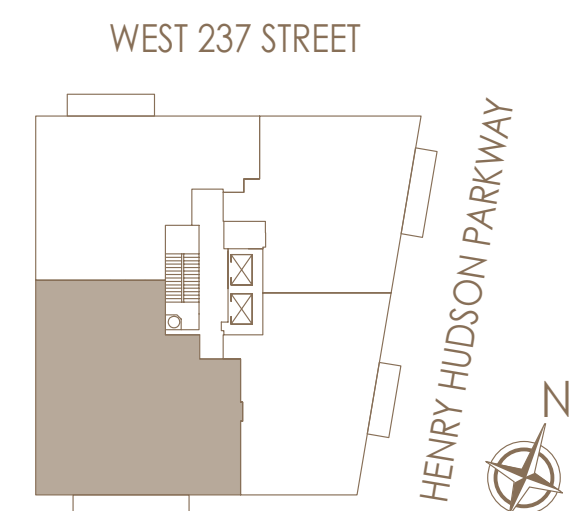

Date: \_\_\_\_\_

Notes: \_\_\_\_\_

\_\_\_\_\_

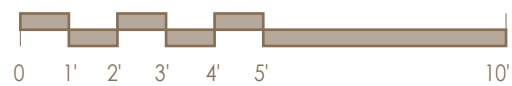

\* Location of plumbing and electric power connections provided behind the base cabinet in kitchen should buyer decide at a later date to furnish and install an additional appliance.